

MATRICULATION AND SECONDARY EDUCATION CERTIFICATE EXAMINATIONS BOARD
UNIVERSITY OF MALTA, MSIDA

SECONDARY EDUCATION CERTIFICATE LEVEL

MAY 2017 SESSION

SUBJECT: **Home Economics**
 PAPER NUMBER: **I**
 DATE: **27th April 2017**
 TIME: **4:00 p.m. to 6:05 p.m.**

Answer ALL questions

1. Protein is one of the macronutrients.

a. Identify the MAIN function of protein in the body.

_____ (1)

b. What happens if there is extra protein which is not used for the function mentioned in part (a)?

_____ (1)

c. Meat is a source of HBV protein. What do HBV and LBV stand for?

HBV: _____ (½)

LBV: _____ (½)

d. In terms of amino acids, outline the difference between HBV and LBV protein foods.

 _____ (2)

e. In the table below, identify **THREE** foods containing LBV protein and **THREE** foods containing HBV protein.

LBV protein	HBV protein

(3)

This question continues on next page.

f. Novel sources of protein are available in supermarkets. John who is a vegan wants to prepare some patties and decides to buy a plant-based substitute to minced beef.

i. Name **TWO** novel sources of protein that John may use as an alternative to minced beef.

_____ (1)

_____ (1)

ii. Plan a one-course meal, including a drink using a novel source of protein that John may prepare. Underline the novel source of protein used in the meal and drink.

One-course meal: _____ (1)

Drink: _____ (1)

(Total: 11 marks)

2. Fish has long been recognised as one of the nature’s best food with a rich supply of nutrients.

a. Name **TWO** different nutrients that are found in fish. State the function of each nutrient in the body.

Nutrient	Function	
_____	_____	(½, 1)
_____	_____	(½, 1)

b. Oily fish and fish liver oils can make a great contribution to one’s diet especially in a particular vitamin.

i. Name this vitamin. _____ (½)

ii. What is the scientific name of this vitamin? _____ (½)

iii. A lack of the above nutrient can result in a deficiency in both children and adults. Identify and explain the effects each deficiency can have in both children and adults.

Deficiency in Children: _____ (½)

Effects of deficiency: _____ (1)

Deficiency in Adults: _____ (½)

Effects of deficiency: _____ (1)

iv. List **TWO** healthy methods of cooking fish.

_____ (1)

v. Name **TWO** different foods rich in carbohydrate that can be served with fish.

_____ (1)

vi. Suggest **TWO** garnishes suitable for fish dishes.

_____ (1)

c. Fish must be used or processed as soon as possible after being caught. Explain why.

_____ (1)

d. Identify **TWO** groups of people for whom fish is particularly suitable. Justify your choice of group.

Group of people	Justification

(1, 2)

e. Give **TWO** advantages of including fish and fish products in the diet.

• _____ (1)

• _____ (1)

(Total: 16 marks)

3. Convenience foods have become increasingly popular in recent years.

a. Give **TWO** explanations for this increase in popularity.

• _____ (1)

• _____ (1)

This question continues on next page.

b. Petra who is 15-years-old decided to make home-made pizza for lunch whereas Peter decided to buy pizza from a take-away kiosk. Outline **TWO** advantages in favour of each of these two choices.

Advantages in favour of Petra’s choice.

- _____ (1)
- _____ (1)

Advantages in favour of Peter’s choice.

- _____ (1)
- _____ (1)

c. Keeping the dietary guidelines in mind, whose choice do you consider to be the best option in terms of health?

_____ (1)

d. Give **TWO** justifications for your choice identified in part (c).

- _____ (1)
- _____ (1)

e. Convenience foods are many times loaded with salt or sugar.

i. Which diet-related disorder is linked to an excessive salt intake?

_____ (1)

ii. Explain **THREE** ways how a person can reduce salt from his/her diet.

- _____ (1)
- _____ (1)
- _____ (1)

(Total: 13 marks)

4. As part of a healthy eating programme, Daniel is deciding on which type of bread he should eat.



Study the information on breads below:

Information on breads				
Bread type	NSP content per slice	Salt content per slice	Fat content per slice	Additional information
A	1.25 g	137.5 mg	0.55 kJ	Made with organic flour
B	1.75 g	70.0 mg	0.75 kJ	Added germ makes this rich in iron
C	1.00 g	135.0 mg	0.42 kJ	Enriched with folic acid
D	2.25 g	70.0 mg	0.40 kJ	No added fat or sugar

a. i. Which bread best suits Daniel’s needs?

Bread Type _____ (½)

ii. Give **TWO** reasons for your choice.

• _____ (1)

• _____ (1)

b. i. Which bread would be most suitable for Daniel’s wife who is two months pregnant?

Bread Type _____ (½)

ii. Give **ONE** reason for your choice.

_____ (1)

iii. Identify **TWO** foods that a pregnant woman should avoid.

_____ (1)

c. i. Which bread would be the most suitable for a person suffering from anaemia?

Bread Type _____ (½)

This question continues on next page.

ii. Justify your choice of bread.

(1)

d. i. Which bread would be the most suitable for a person who is concerned about the environment?

Bread Type _____ (½)

ii. Justify your choice of bread.

(1)

iii. Draw the symbol that can be found on this bread.

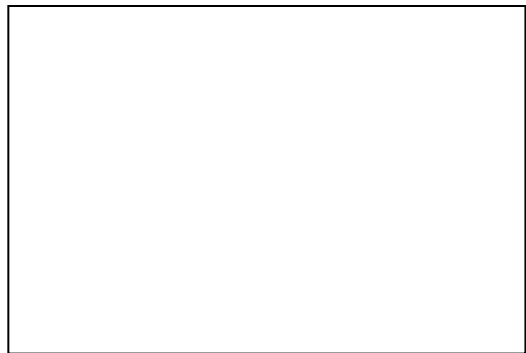

(2)

(Total: 10 marks)

5. The Borg family enjoy preparing home-made food, particularly pastry dishes.

a. Which labour-saving device can they purchase to aid them in the making of shortcrust pastry?

(1)

b. The following are the ingredients that they use to make shortcrust pastry. Make **TWO** modifications to these ingredients to make them more in line with the dietary guidelines.

Shortcrust pastry ingredients used by the Borg family	Modified shortcrust pastry ingredients
250g plain white flour	
125g lard	
Pinch of salt	
Cold water	

(2)

c. Explain why you made the **TWO** modifications to the above list of ingredients.

Modification 1: _____
 _____ (1)

Modification 2: _____
 _____ (1)

d. Suggest **TWO** sweet and **TWO** savoury dishes that they can make with shortcrust pastry.

Sweet dishes	Savoury dishes

(2)

e. Apart from making pastry, this family can use their labour-saving device for other purposes. Identify another **THREE** ways of how this family can make use of it.

- _____ (1)
- _____ (1)
- _____ (1)

f. Explain why labour-saving devices have become important in modern kitchens.
 _____ (1)

(Total: 11 marks)

6. A student was preparing the evening meal for friends.

Read the list of actions that took place whilst she was preparing and cooking the meal.

Action 1	The chicken was not fully defrosted, but it was planned to be cooked in the oven for about 1 hour 30 minutes. She thought this would be all right.
Action 2	The chicken was sitting on a plastic chopping board that was later used to chop vegetables for a cold rice salad.
Action 3	The cheesecake had not fully defrosted so it was left to defrost by an open window.

a. Explain the possible outcome for each action listed above.

Actions	Possible outcomes
Action 1	<hr/> <hr/> <hr/> (2)
Action 2	<hr/> <hr/> <hr/> (2)
Action 3	<hr/> <hr/> <hr/> (2)

b. Suggest **TWO** food safety tips that the student need to follow during the preparation, cooking and serving food.

Preparation of food:

- _____ (1)
- _____ (1)

Cooking food:

- _____ (1)
- _____ (1)

Serving food:

- _____ (1)
- _____ (1)

c. Give **TWO** examples of high-risk foods served in this evening meal.

_____ (1)

d. State **TWO** conditions that bacteria need to multiply rapidly.

_____ (1)

e. Name **TWO** bacteria which may cause food poisoning.

_____ (1)

f. Mention **TWO** possible symptoms of food poisoning,

_____ (1)

(Total: 16 marks)

Please turn the page.

7. Trifle is a very popular Maltese dessert amongst people. The following are the ingredients required for a traditional Maltese Trifle.

Traditional Maltese Trifle		
Ingredients:		
<i>Sponge</i>	<i>Filling</i>	<i>Custard</i>
3 eggs	300ml fresh cream	500ml full fat milk
75g sugar	100g sugar	120g sugar
75g flour	1 tin canned chopped fruit	40g custard powder
<i>To decorate:</i> candied cherries		

a. Name **THREE** ingredients found in the list of ingredients in the table above that are not in line with the dietary recommendations. For each ingredient, suggest a healthy alternative.

Ingredient 1: _____ Alternative: _____ (1)

Ingredient 2: _____ Alternative: _____ (1)

Ingredient 3: _____ Alternative: _____ (1)

b. Identify the method of cake-making to make a sponge mixture.

_____ (1/2)

c. List **THREE** small kitchen equipment needed to make a sponge.

_____ (1 1/2)

d. Why is the sponge considered to be one of the healthiest method of cake-making?

_____ (1)

e. Flour should be folded-in very lightly when making a sponge mixture.

i. Why is it recommended to use a metal spoon to fold in the flour?

_____ (1)

iii. What happens if the mixture is whisked instead of folded-in at this stage?

_____ (1)

(Total: 8 marks)

8. As children reach adolescence, their food habits may change.

a. Explain briefly **THREE** factors that may contribute to this change.

- _____ (1)
- _____ (1)
- _____ (1)

b. Sarah is a 16-year-old who has been advised to increase her intake of iron. Suggest **FOUR** foods that she could have in order to increase the iron in her diet.

- _____ (½)
- _____ (½)
- _____ (½)
- _____ (½)

c. i. Identify a macronutrient that may be increasingly necessary during childhood and adolescence.

_____ (1)

ii. Explain the need for this macronutrient.

 _____ (2)

d. During the weekend, Sarah enjoys going out with her friends for a snack. This is what she and her friends had last Sunday.

Sarah	Hot dog Bag of chips Soft drink
Maria	Beef burger Doughnut Ice tea
Anne	3 cheesecakes 1 soft drink

This question continues on next page.

After carefully analysing their choice of food and drink, suggest why these three friends should avoid:

i. eating junk food:

- _____ (1)
- _____ (1)

ii. drinking soft drinks:

- _____ (1)
- _____ (1)

e. Keeping the dietary guidelines in mind, identify **TWO** healthy snack foods and **TWO** healthy beverages that this group of friends might choose when out.

Healthy snack foods

- _____
- _____ (1)

Healthy beverages

- _____
- _____ (1)

f. Apart from carefully considering what foods and drinks to consume, identify **ONE** other way how these teenagers can maintain a healthy lifestyle.

_____ (1)

(Total: 15 marks)

MATRICULATION AND SECONDARY EDUCATION CERTIFICATE EXAMINATIONS BOARD
UNIVERSITY OF MALTA, MSIDA

SECONDARY EDUCATION CERTIFICATE LEVEL

MAY 2017 SESSION

SUBJECT: **Home Economics**
 PAPER NUMBER: IIA
 DATE: 28th April 2017
 TIME: 4:00 p.m. to 6:05 p.m.

SECTION A - Answer ALL questions

1. Anne and Mark are a married couple in their late forties. They are moving into a new home because they need more space for their growing family.



a. Identify **THREE** main factors that Anne and Mark should consider when choosing kitchen appliances for a family home.

- _____ (1)
- _____ (1)
- _____ (1)

b. Anne and Mark are not sure if they should buy a dishwasher for their growing family. Why would this family benefit if they install a dishwasher?

- _____ (1)
- _____ (1)

c. Outline **TWO** different energy saving measures that the family could take when using the electric dishwasher. Explain why each measure will help to save energy.

- i. _____
 Why? _____ (2)
- ii. _____
 Why? _____ (2)

(Total: 9 marks)

2. Amanda is a first-year University student sharing a flat with two other students. She has a weekly allowance of €89 to cover all her University expenses including rent. She walks to University.



a. Why should Amanda set out a budget?

_____ (1)

b. List the MAIN expenses that Amanda should consider when allocating her money to ensure that her needs are met. Indicate both essential and dispensable expenses.

_____ (4)

Amanda lost her mobile phone and had to buy a new one. She saw a lot of adverts in various media but was still confused which model to buy.

c. List **FOUR** techniques commonly used in the media which attract consumers to buy products.

_____ (2)

d. Suggest **THREE** ways how Amanda can avoid being misled when shopping.

- _____ (1)
- _____ (1)
- _____ (1)

(Total: 10 marks)

3. A British couple decides to come and live in Malta. They are still unaware of how household waste is collected.

a. What is household waste?

(1)

b. Identify **THREE** ways how the couple can help protect the environment.

- _____ (1)
- _____ (1)
- _____ (1)

c. The couple would like to separate waste at source before taking it to the bring-in-site. Explain the importance of this good practice.

(1)

d. List **THREE** things that the couple should do before taking waste to the bring-in-site.

- _____ (1)
- _____ (1)
- _____ (1)

e. Name **TWO** items which cannot be taken to the bring-in-site.

(1)

f. Give **ONE** practical example how the couple can be environmental friendly when:

i. shopping for grocery items: _____
_____ (1)

ii. disposing of electrical appliances: _____
_____ (1)

(Total: 11 marks)

4. Joseph and Maria are married and have two children, Sarah aged 13 and Samuel aged 11. They both have full time jobs. They decide to foster a child, Luke aged 6.

a. Explain the difference between fostering and adoption.

(2)

b. Give **ONE** reason why a child may be fostered.

(1)

c. Identify **TWO** ways how Sarah and Samuel can help out their family especially when Luke arrives?

• _____ (1)

• _____ (1)

d. Such a change in this family’s life may be stressful. Write another **TWO** sources of stress that may affect a family.

• _____ (1)

• _____ (1)

e. Outline **TWO** ways how families going through stressful situations can cope with stress.

• _____ (1)

• _____ (1)

f. Explain **ONE** way how Luke can benefit from this fostering experience.

(1)

(Total: 10 marks)

SECTION B – Answer ALL questions

5. Robert and Jessica recently had their first baby.

a. Suggest **THREE** actions that will help their baby to have a healthy physical development.

- _____ (1)
- _____ (1)
- _____ (1)

b. A child also needs to develop socially. Explain **THREE** ways how these parents can give their child opportunities to develop socially.

- _____ (1)
- _____ (1)
- _____ (1)

c. Identify **TWO** intellectual needs of a young child.

- _____ (1)
- _____ (1)

d. Name the incentive that the Maltese Government has recently introduced to help working parents with pre-school children.

_____ (1)

e. The state also provides a Vaccine Programme offered by the National Immunisation Services. Why it is important for these new parents to immunise their child?

- _____ (1)
- _____ (1)

This question continues on next page.

f. Identify **TWO** illnesses that the child should be immunised against before s/he starts attending kindergarten.

- _____ (½)
- _____ (½)

g. These parents are also concerned in providing a safe environment for their child. Give **TWO** examples how these parents can make their home safer for their young child.

- _____ (1)
- _____ (1)

h. Small children tend to put many things in their mouth. What procedure should these parents follow if their child has put a small particle of a toy and is showing signs that she is choking on it.

Step 1: _____
_____ (1)

Step 2: _____
_____ (1)

i. The family have a second child who suffers from Down's syndrome. Outline **TWO** changes that this disability may have on the family.

- _____
_____ (1)
- _____
_____ (1)

j. Describe **TWO** ways how children with a disability and their families can be helped to integrate in society.

- _____
_____ (1)
- _____
_____ (1)

(Total: 20 marks)

6. The main function of the kitchen is the preparation of food. However, most families tend to use the kitchen for other purposes too.

a. Identify **TWO** other functions for which the kitchen may be used.

- _____ (1)
- _____ (1)

b. Give **TWO** reasons why it is important for the kitchen layout to be well planned.

- _____ (1)
- _____ (1)

c. Define the term *ergonomic kitchen*.

_____ (1)

This question continues on next page.

d. Look closely at the kitchen plan below. This is the kitchen plan of the Borg family. In this plan, all working areas are close to each other. Name the **THREE** areas in the kitchen which are at the points of the imaginary work triangle.

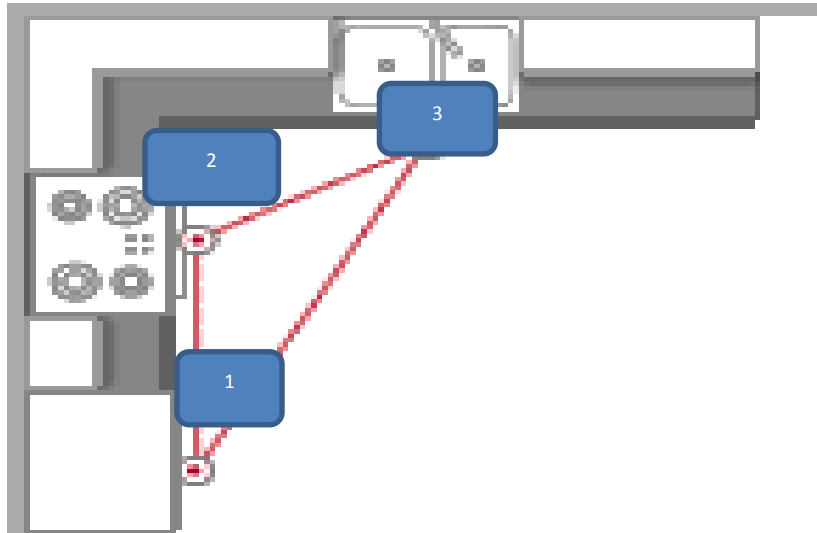

Area 1: _____

(1/2)

Area 2: _____

(1/2)

Area 3: _____

(1/2)

e. The family needs to change their kitchen layout as they want to buy a chest freezer.

i. In the box below, design a U-shaped kitchen. Include the addition of a chest freezer and give careful consideration to the areas of the work triangle.



(1)

ii. On the diagram in part e(i), show clearly the three areas of the work triangle and label them as area 1, 2 and 3.

Area 1 is showing the _____ (½)

Area 2 is showing the _____ (½)

Area 3 is showing the _____ (½)

f. Give **TWO** advantages of having a chest freezer.

_____ (1)

_____ (1)

g. This family would also like your advice on other issues related to their kitchen.

i. Explain to them **TWO** important characteristics of a floor covering that would be suitable for use in their kitchen.

_____ (1)

_____ (1)

ii. Why is it essential to have good lighting in the kitchen?

_____ (1)

_____ (1)

iii. Give **TWO** ideas how to create a well-lit kitchen.

_____ (½)

_____ (½)

iv. Suggest **TWO** factors to consider when choosing a suitable worktop surface in the kitchen.

_____ (1)

_____ (1)

h. Describe **TWO** ways to help minimise their electricity bills when planning their kitchen.

_____ (1)

_____ (1)

(Total: 20 marks)

7. George is 65-years-old and lives on his own. He enjoys his food and likes to eat well, but has mobility problems. His neighbour, Maria, does most of his weekly shopping for him.

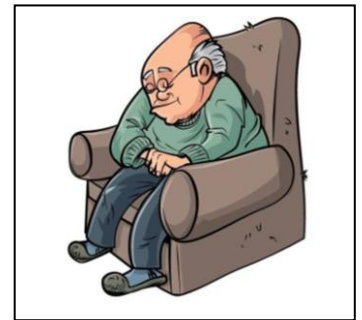

a. Maria does her shopping every Wednesday from either market stalls or a corner shop. Outline **ONE** advantage and **ONE** disadvantage of shopping from each shopping outlet.

Market stalls:

Advantage: _____ (1)

Disadvantage: _____ (1)

Corner shop:

Advantage: _____ (1)

Disadvantage: _____ (1)

b. Discuss **FOUR** changes that have occurred in shopping practices in recent years, apart from online shopping.

_____ (4)

c. George's daughter Anne, has been encouraging her father to shop for food online.

i. Define online shopping.

_____ (1)

ii. Outline **THREE** benefits that Anne should explain to her father to encourage him to shop online.

• _____ (1)

• _____ (1)

• _____ (1)

iii. List **THREE** precautions that George needs to take when shopping online.

_____ (1)

_____ (1)

_____ (1)

iv. Which is the best method of payment should George use to pay online?

_____ (1)

d. Over the years, George managed to put aside some savings. Unfortunately, he is not receiving good interest from his savings account. His daughter encouraged him to invest them in bonds or shares. In your own words explain the difference between bonds and shares.

_____ (4)

(Total: 20 marks)

Blank Page

MATRICULATION AND SECONDARY EDUCATION CERTIFICATE EXAMINATIONS BOARD
UNIVERSITY OF MALTA, MSIDA

SECONDARY EDUCATION CERTIFICATE LEVEL

MAY 2017 SESSION

SUBJECT: **Home Economics**
 PAPER NUMBER: **IIB**
 DATE: **28th April 2017**
 TIME: **4:00 p.m. to 6:05 p.m.**

SECTION A - Answer ALL questions

1. Anne and Mark are moving house because they need more space for their growing family.

a. Identify **THREE** factors that Ann and Mark need to consider when choosing their new kitchen appliances.



- _____ (1)
- _____ (1)
- _____ (1)

b. Give **TWO** advantages and **TWO** disadvantages of buying a dishwasher.

Advantages:

- _____ (1)
- _____ (1)

Disadvantages:

- _____ (1)
- _____ (1)

c. Describe **TWO** different energy saving measures, other than the example below, that the family could take when using the electric dishwasher.

An example has been provided: Example: Reduce the washing temperature if possible.

- i. _____ (1)
- ii. _____ (1)

(Total: 9 marks)

2. Amanda is a first-year University student who is renting a flat with two other students. The flat is very close to University.



a. Why is it important for Amanda to make a budget?

_____ (2)

b. Fill-in the table below to show **TWO** types of income and **SIX** types of expenses that Amanda may have.

Income	Expenses

(4)

Amanda had to buy a new mobile.

c. List **FOUR** techniques commonly used in adverts which encourage consumers to buy their products.

Example: A free product such as a mobile cover is given.

_____ (2)

d. Suggest **TWO** ways how Amanda can avoid being misinformed when shopping.

• _____ (1)

• _____ (1)

(Total: 10 marks)

3. A British couple, decides to come and live in Malta. They asked you to give them some information about household waste.

a. What is household waste?

Household waste is waste which is generated in the day to day running of a household. It may include everything from _____ to _____. It may also contain hazardous waste such as _____ and _____. (2)

b. Identify **ONE** way how the British couple can help to protect the environment.

 _____ (1)

c. i. The couple would like to separate their waste and then take it to a bring-in-site. What should they do before taking their waste to the bring-in-site?

- _____ (1)
- _____ (1)
- _____ (1)

ii. The following items form part of the waste that is collected by the couple. Sort the following waste into the correct bring-in site bin.

Margarine tub	Tuna cans	Empty shower gel	Wine bottles
Aluminium cans	Jam jars	Frozen food boxes	Newspaper

This question continues on next page.

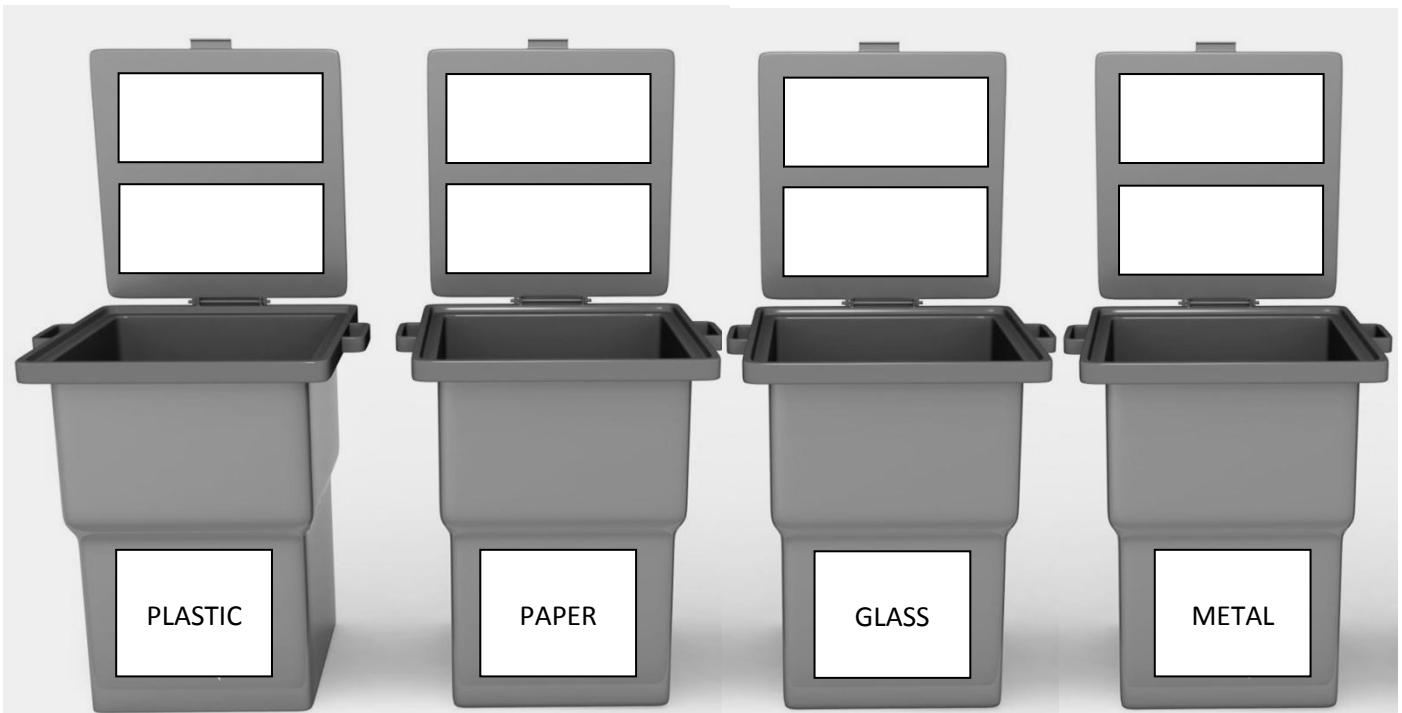

(2)

iii. Can the couple place all the above waste in the grey/ green bag for home collection? Explain.

_____ (1)

iv. Name **TWO** items which cannot be taken to the bring-in-site.

_____ (1)

v. How can the couple be environmentally friendly when disposing of electrical appliances?

_____ (1)

(Total: 11 marks)

4. The following are two different family situations. Read them well and answer the questions that follow.

Situation A
Joseph and Maria are married and have two children, Sarah aged 13 and Samuel aged 11. They both have full-time jobs. They decide to look after Luke, a 6-year-old child, whose parents at the moment cannot look after him for a few years.

Situation B

Philip and Sharon are married but cannot have any children. They decided to help out a child in need whose parents are dead. They will legally become the child’s parents and look after the child as if he was their own.

- a. Give the name of the two family types explained in situation A and in situation B.
 - Type of family in situation A: _____ (1)
 - Type of family in situation B: _____ (1)
- b. Explain **TWO** advantages that the child has in situation A.
 - _____ (1)
 - _____ (1)
- c. Identify **TWO** sources of stress that families in both situation A and in situation B may go through.
 - _____ (1)
 - _____ (1)
- d. The arrival of a new member in the family can be difficult. Write another **TWO** sources of stress that may affect a family.
 - _____ (1)
 - _____ (1)
- e. Outline **TWO** ways how families going through stressful situations can reduce their stress levels.
 - _____ (1)
 - _____ (1)

(Total: 10 marks)

Please turn the page.

SECTION B – Answer ALL questions

5. Robert and Jessica recently had their first baby.

a. The following developmental milestones are all part of a child’s physical, social and intellectual development. Place each one of these developmental milestones under the correct heading.

- Throws a ball
- Reads simple books
- Goes up and down the stairs
- Is friendly and affectionate with parents
- Shares toys with playmates
- Starts to sing alphabet songs

Physical development:

- _____ (½)
- _____ (½)

Social development:

- _____ (½)
- _____ (½)

Intellectual development:

- _____ (½)
- _____ (½)

b. Suggest **THREE** factors that are essential for a child’s healthy physical development.

- _____ (1)
- _____ (1)
- _____ (1)

c. Going to the playground is one way of helping a child to develop socially. Explain another **THREE** ways how these parents can help the child in his social development.

- _____ (1)
- _____ (1)
- _____ (1)

d. Recently, the Maltese government has introduced free _____ to help working parents with pre-school children. (1)

e. The home can be a very dangerous place for a child. It is important for families to have a well-equipped first-aid box. Identify **FOUR** items that should be found inside the first-aid box.

- _____ (½)
- _____ (½)
- _____ (½)
- _____ (½)

f. Look carefully at the pictures below.



Picture 1



Picture 2

i. What is the danger in Picture 1?

_____ (1)

ii. How can this danger be avoided?

_____ (1)

iii. What is the danger in Picture 2?

_____ (1)

iv. How can this danger be avoided?

_____ (1)

The family has a second child who suffers from Down’s syndrome.

g. Describe **TWO** changes that this disability may have on the family.

• _____
_____ (1)

• _____
_____ (1)

h. Explain **TWO** ways how children with a disability and their families can be helped to integrate in society.

• _____
_____ (1)

• _____
_____ (1)

(Total: 20 marks)

6. The kitchen is mainly used for the preparation of food. However, most families tend to use the kitchen for other purposes too.

a. Identify **TWO** other functions for which the kitchen may be used.

• _____ (1)

• _____ (1)

b. Why is it important for the kitchen layout to be well planned?

- _____ (1)
- _____ (1)

c. Use the words below to correctly complete the sentence.

ergonomic, designed, efficient

An _____ kitchen is a kitchen that is _____ and planned in a way that is safe, _____ and easy to work in. (1½)

d. A kitchen can be designed in a variety of ways. Look carefully at the kitchen plans shown below and for each one write the name of that particular design.

i.

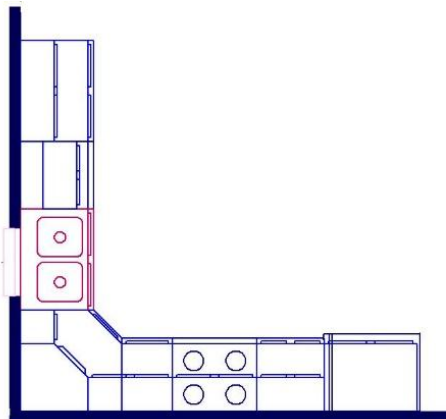

ii.

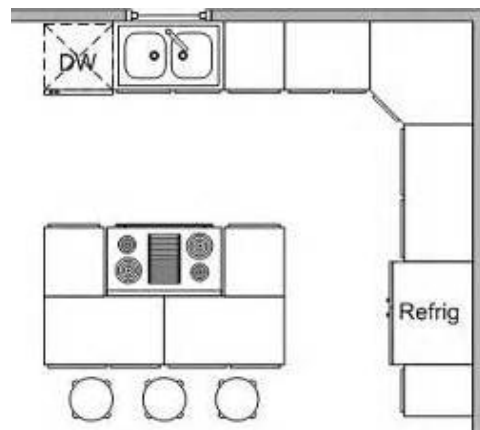

iii.

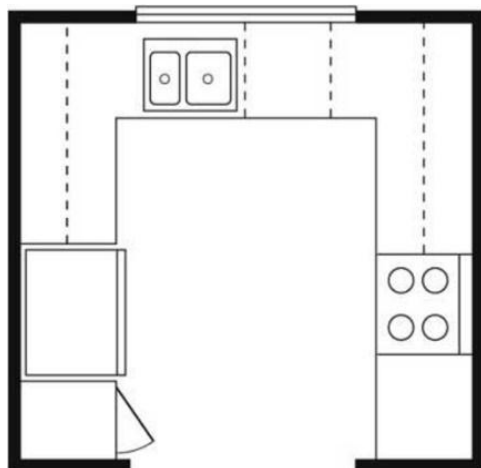

_____ (3)

This question continues on next page.

e. In each kitchen plan, there is the work triangle. What does the work triangle consist of?

- _____ (½)
- _____ (½)
- _____ (½)

f. Sarah and Steve want to buy a chest freezer for their kitchen. Give **TWO** advantages of having a chest freezer.

- _____ (1)
- _____ (1)

g. Sarah and Steve ask for some advice related to their kitchen. Floor covering in the kitchen should be non-slip.

i. Describe another **TWO** characteristics that make a good floor covering for the kitchen.

- _____ (1)
- _____ (1)

ii. Give **TWO** ideas how to make a well-lit kitchen.

- _____ (1)
- _____ (1)

iii. Suggest **TWO** factors to consider when choosing a suitable worktop surface for the kitchen.

- _____ (1)
- _____ (1)

h. Describe **TWO** ways how they can make wise choices when planning their kitchen in order to help minimise their electricity bills when planning their kitchen.

- _____ (1)
- _____ (1)

(Total: 20 marks)

7. George is 65-years-old and lives on his own. He has health problems and finds it difficult to walk to the shops. Maria, his neighbour, does most of his weekly shopping for him.

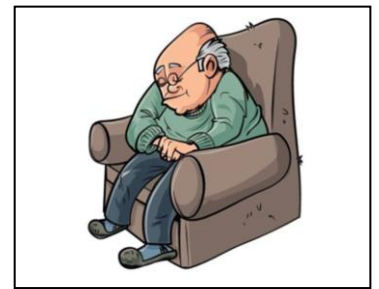

a. Maria does her shopping from market stalls or from a corner shop. List **ONE** advantage and **ONE** disadvantage of shopping from each shopping outlet.

Market stalls:

Advantage: _____ (1)

Disadvantage: _____ (1)

Corner shop:

Advantage: _____ (1)

Disadvantage: _____ (1)

b. Identify **THREE** changes that have occurred in shopping practices in recent years, apart from online shopping.

• _____ (1)

• _____ (1)

• _____ (1)

c. George's daughter, Anne, has encouraged her father to start shopping online.

i. Tick (✓) next to the correct definition of online shopping.

Online shopping is the process consumers connect with people using social media.

Online shopping involves the process of shopping for a product or service by using a landline.

Online shopping is the process consumers go through to purchase a product or a service over the use of the internet.

(1)

ii. List **THREE** advantages of online shopping.

• _____ (1)

• _____ (1)

• _____ (1)

iii. Identify **FOUR** items that George can buy online.

_____ (2)

iv. List **THREE** tips that Anne should give to her father before he starts to shop online.

- _____ (1)
- _____ (1)
- _____ (1)

v. George will be using a credit card to pay online. What is a credit card?

_____ (1)

d. Over the years, George managed to save up some money. Unfortunately, he is not receiving good interest from his savings account. His daughter encouraged him to invest them in bonds or shares or to open a fixed account.

Fill-in the blanks using the words provided:

bonds	fixed account	dividends
debt	interest	shares

In a _____, the customers invest up their savings for fixed periods with interest earned varying according to the term of deposit and amount invested. _____ may vary from one bank to another or depending on the amount of months the money are kept in the bank.

_____ represent an ownership interest in a company. _____ are a form of long-term _____ in which the issuing company promises to pay the principal amount at a specific date. Shares pay _____ to the owners, but only if the company declares. (3)

(Total: 20 marks)